

# POWERFLEX®

## PART NUMBER

# PFR32-712

## DESCRIPTION

### REAR LOWER FRONT CONTROL ARM OUTER BUSH

## INSTALLATION GUIDE

### Contents (parts per pack):

- 4 x Polyurethane Bushes
- 1 x PTFE/Silicone Grease
- 2 x Stainless Steel Sleeves
- 2 x Zinc Plated Mild Steel Outer Shells

Please read the complete fitting instructions and check package components before fitment. These fitting instructions are to be used as a guide and in conjunction with workshop manual.

It is recommended that:

- all work to be carried out by a licensed technician;
- all safety precautions adhered to;
- wheel alignment to be checked and adjusted as required after any suspension work.
- All fasteners must be tensioned to manufacturer's torque settings.



### Fitting Instructions:

1. Remove the original rubber bush from the rear lower front control arm.
2. Clean any dirt and corrosion from the bore of the arm and file off any sharp edges.
3. Press the zinc-plated mild steel outer shell into the bore of the arm so the lip sits flush against the top of the arm.
4. Push the polyurethane part into the bore of the outer shell so it sits flush against the lip.
5. Apply the supplied grease to the bore of the polyurethane bush and insert the stainless steel sleeve into the bore of the bush so it sits flush.
7. Refit the rear lower front control arm to the vehicle and tension all hardware to manufacturers recommended torque settings.

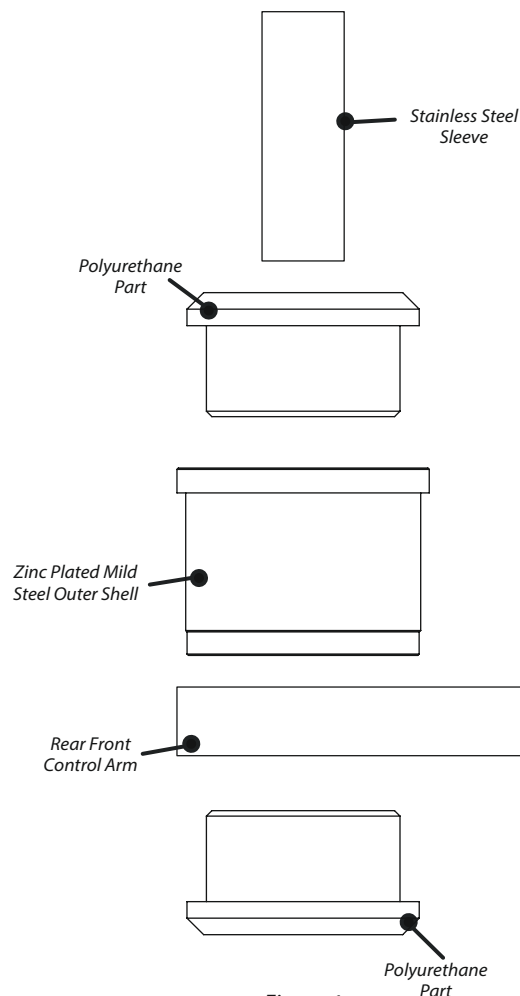

Figure 1